

kōjin kyoto

BUILDING INFORMATION

English Version

2023

kojin kyoto has four floors.
The first and second floors are the main exhibition space,
The 3rd floor is a convenient space for receptions, etc.,
with an L-shaped counter and kitchen attached
and B1F is a space that can be used as a backspace
with a restroom and a stockroom.

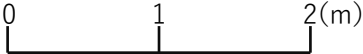
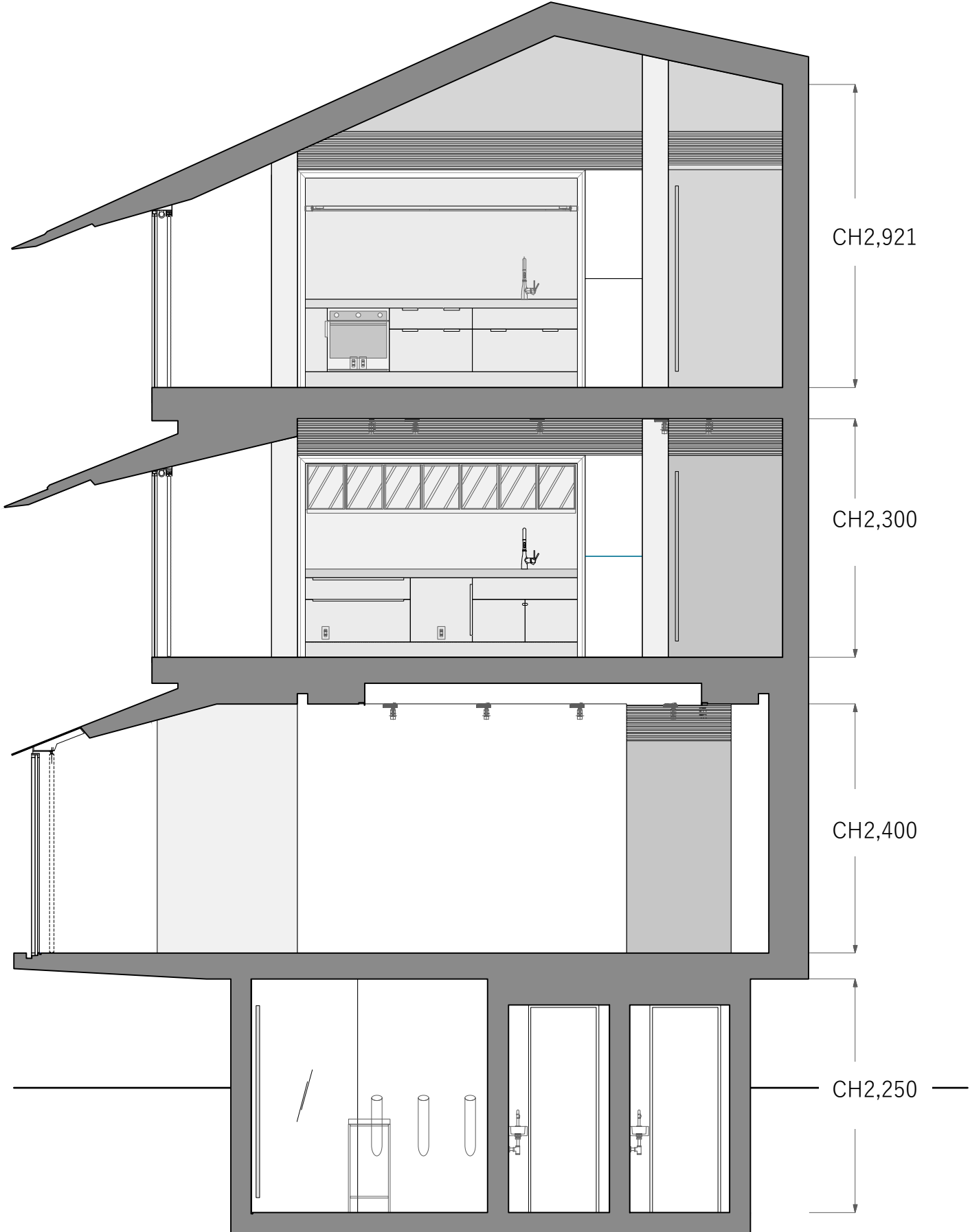

B1F

FLOOR Plan | Scale 1/50

kōjin kyoto

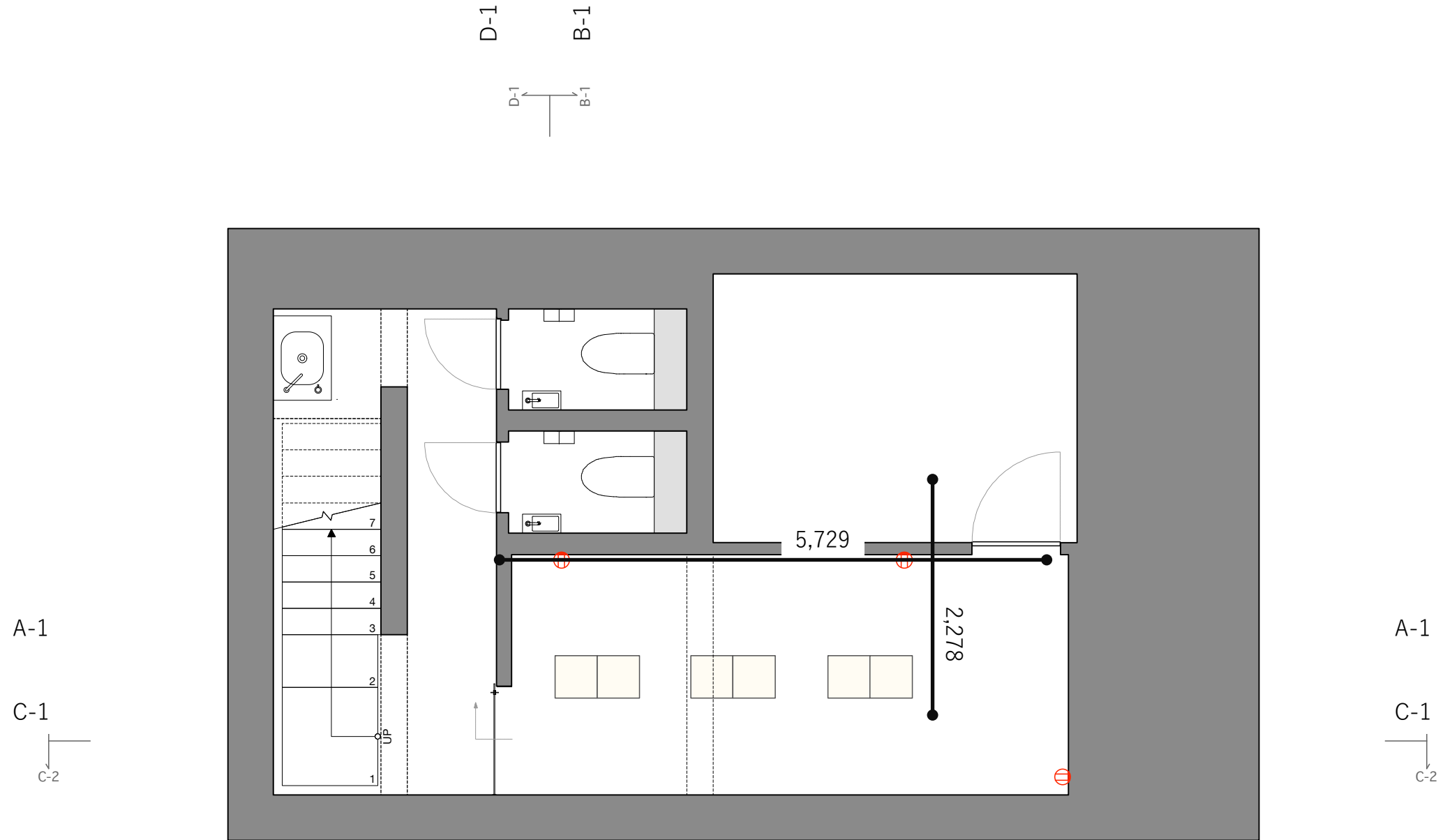

⊕ = Wall outlet

0 1 2(m)

B1F

LIGHTING Plan | Scale 1/50

kōjin kyoto

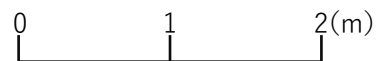
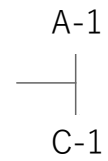
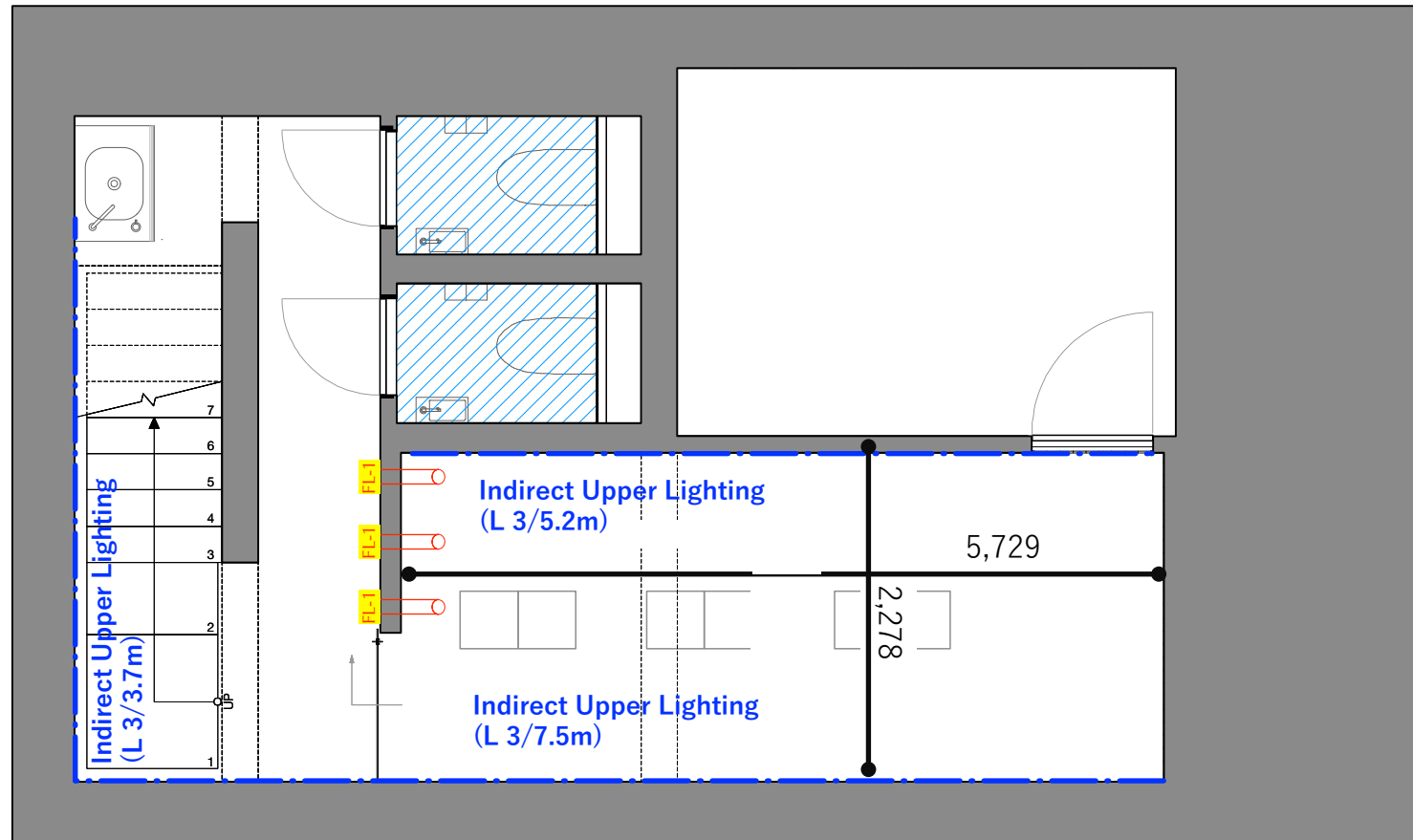
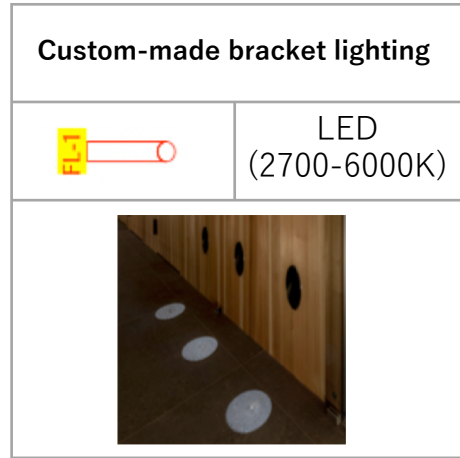
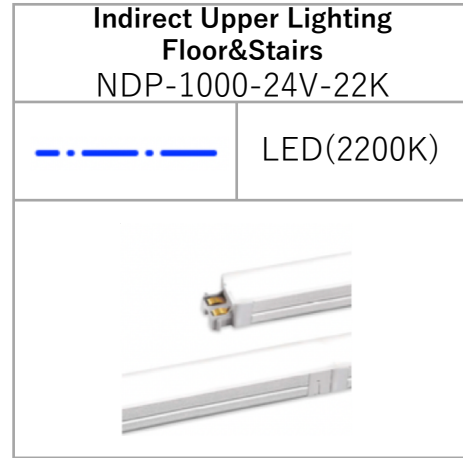

SECTION A-1

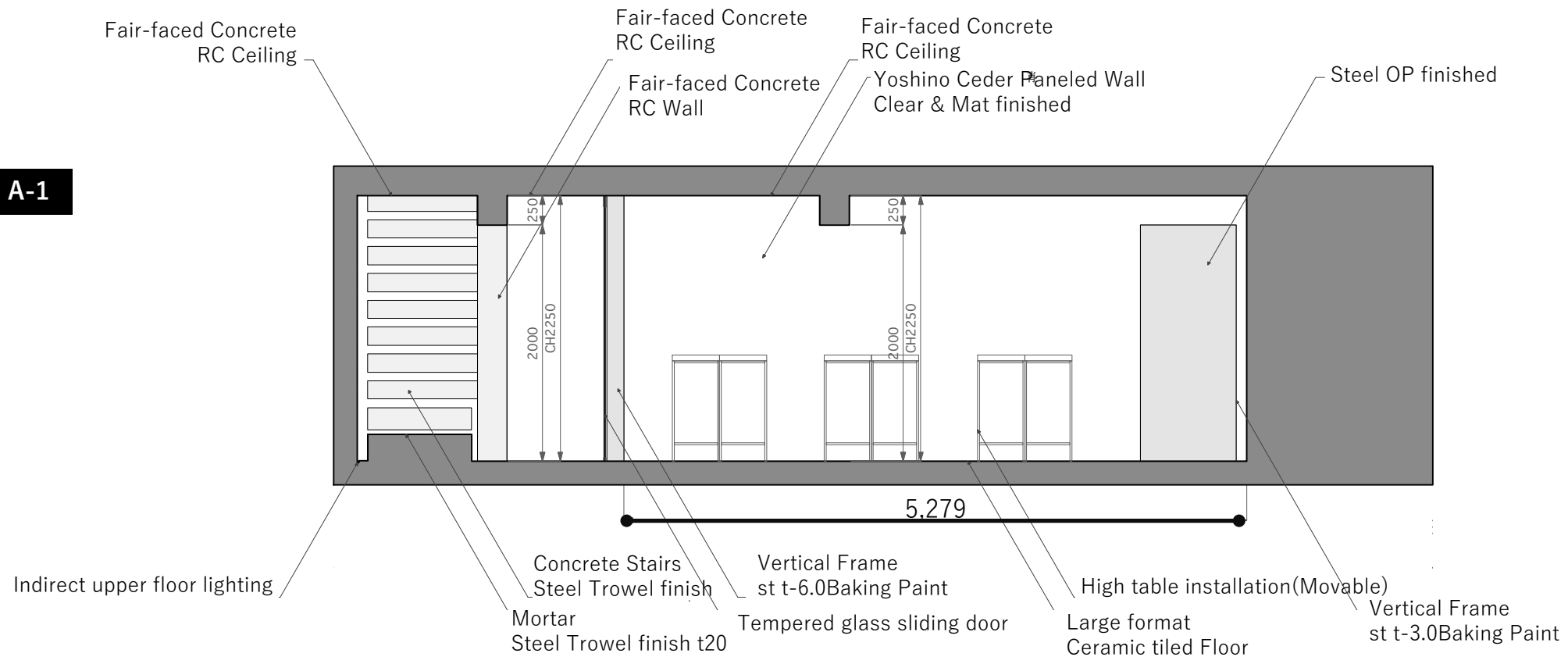

SECTION C-1

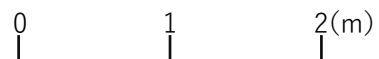
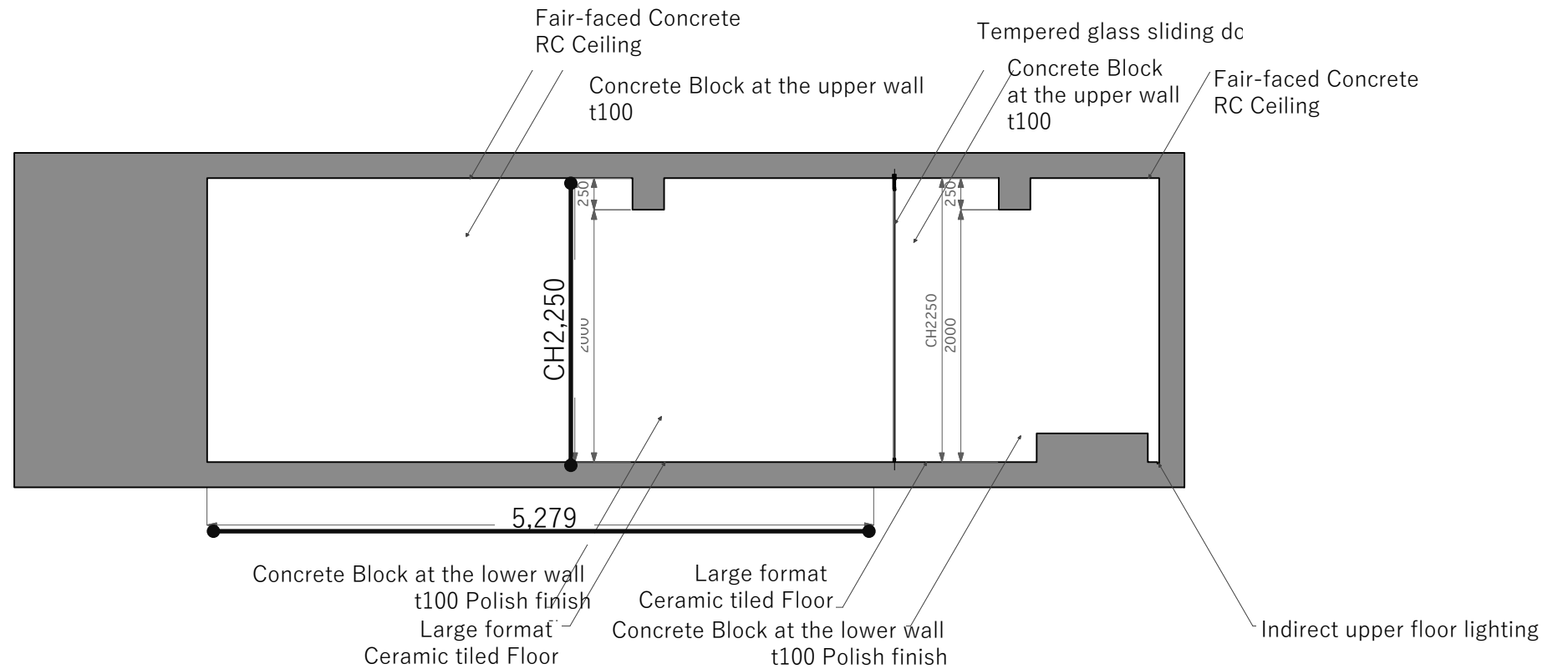

SECTION B-1

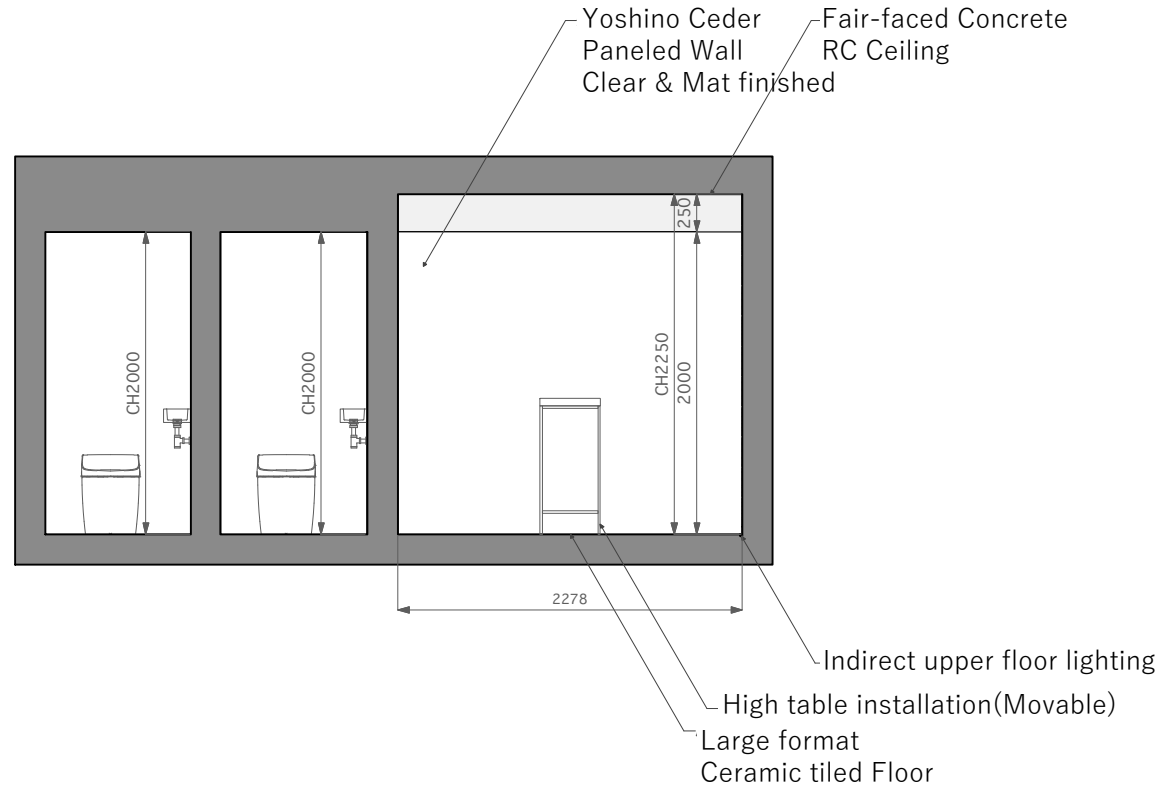

SECTION D-1

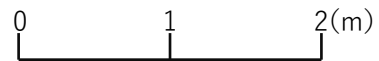
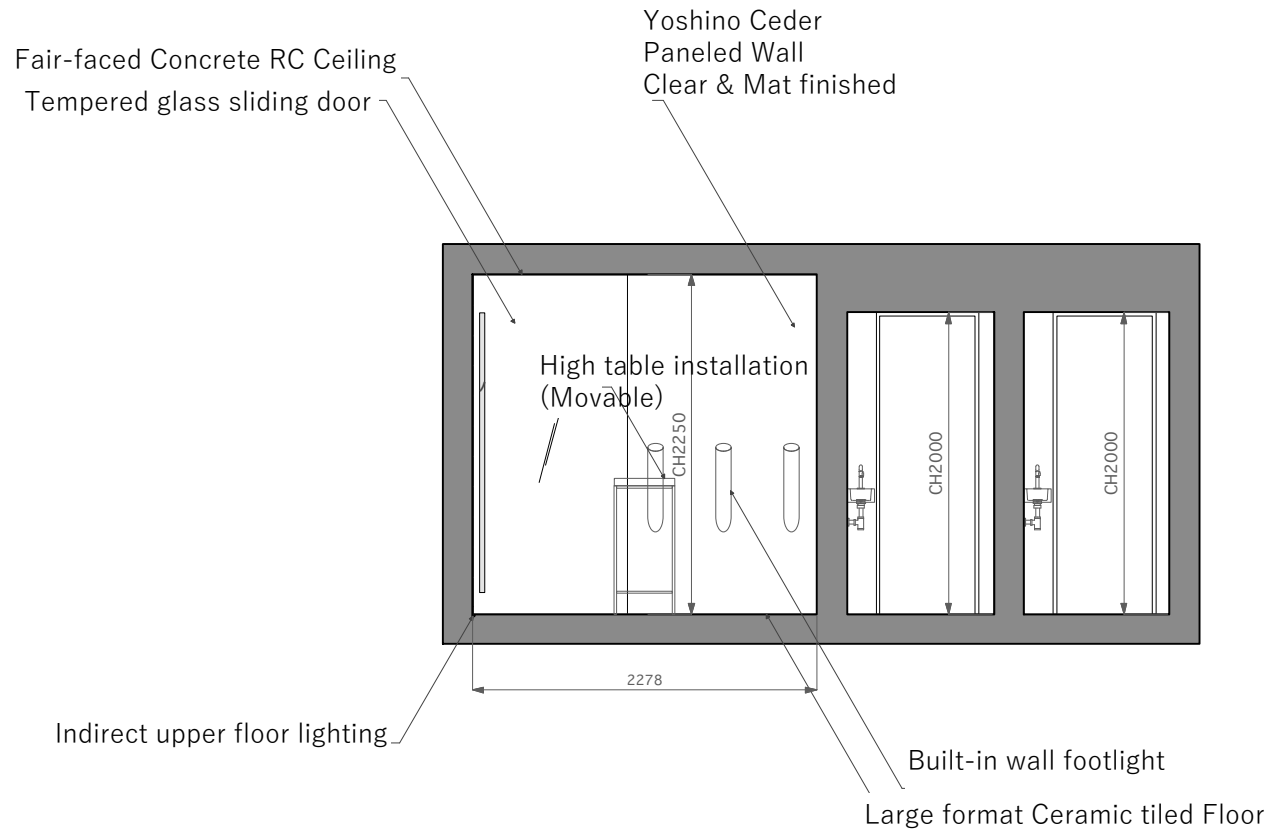

1F

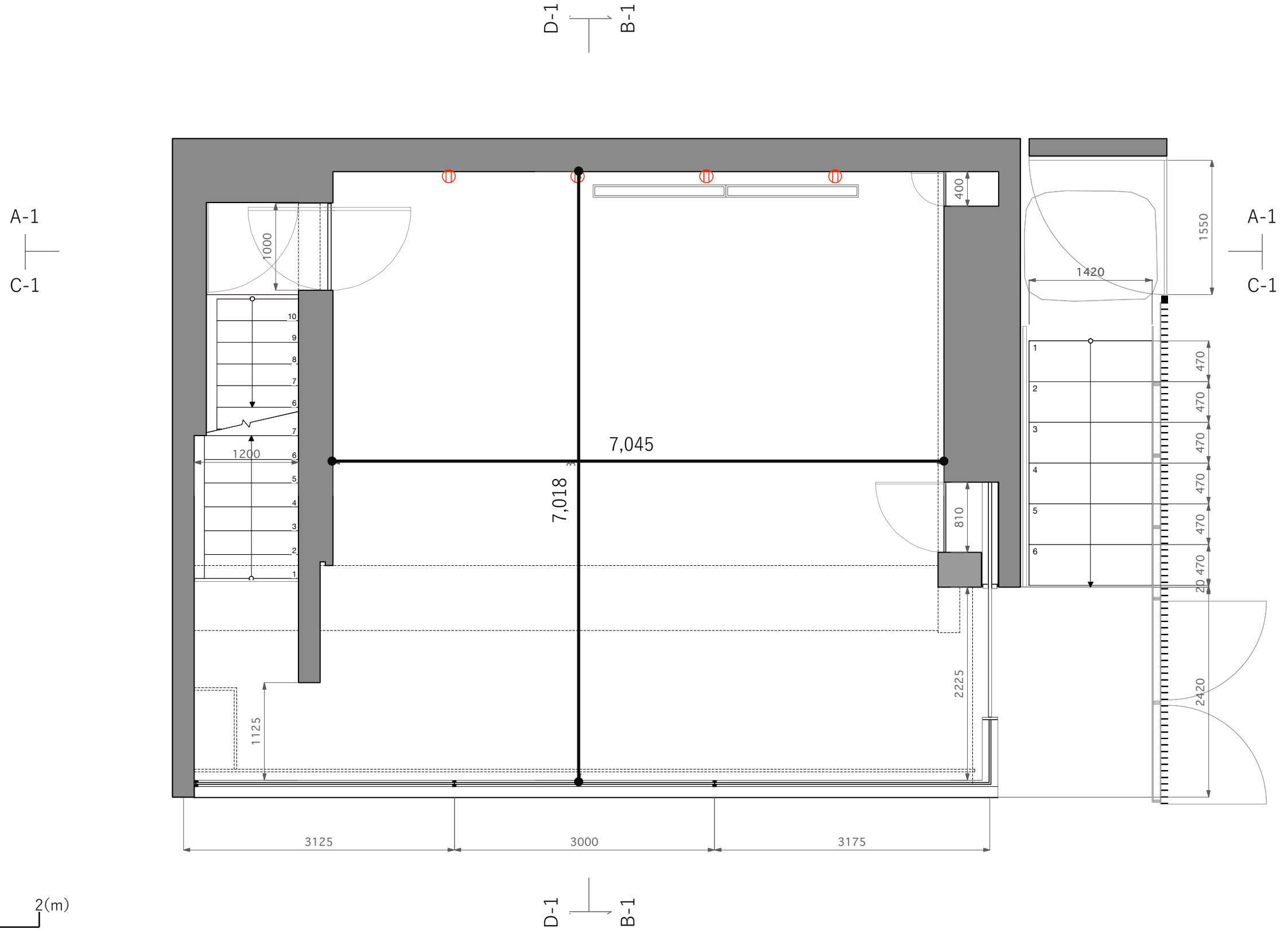

FLOOR Plan | Scale 1/50

kōjin kyoto



Plug Spot Light ERS6369W+RB685W+RB-683F	
	LED(3000K)
	

Line Lighting DDP-3-WC-24V-S/DDP-18WC-24 DDP-24WC-24V	
	LED (2700-6000K)
	

Indirect Upper Lighting Floor&Stairs NDP-1000-24V-22K	
	LED(2200K)
	

Down Universal Light SDL8306ALL-MV	
	LED(2700K)
	

Spike Spot Light LLS-7105LUM+LLA-7119U	
	LED(2700K)
	

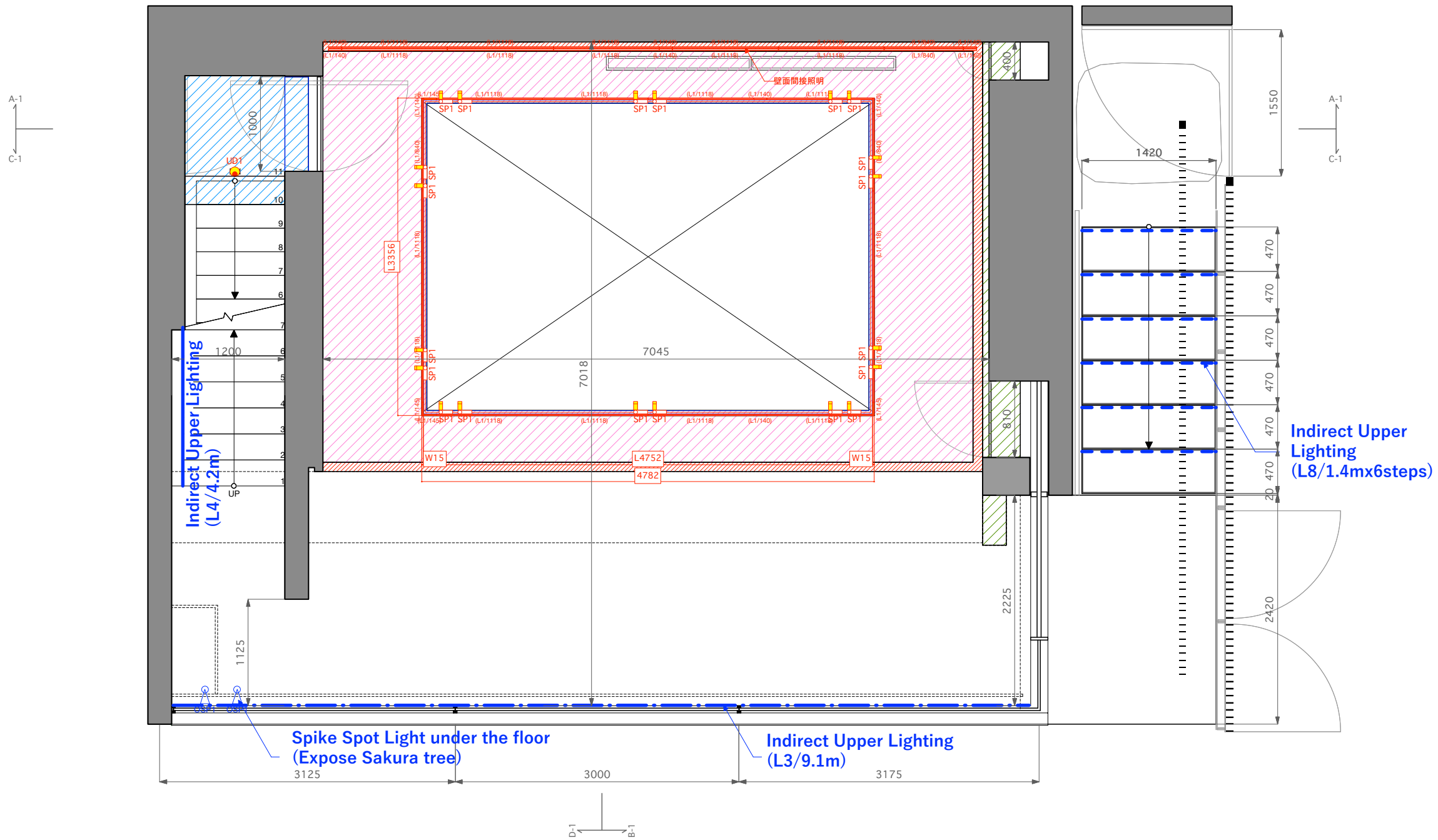

SECTION-1 | Scale 1/50

SECTION A-1

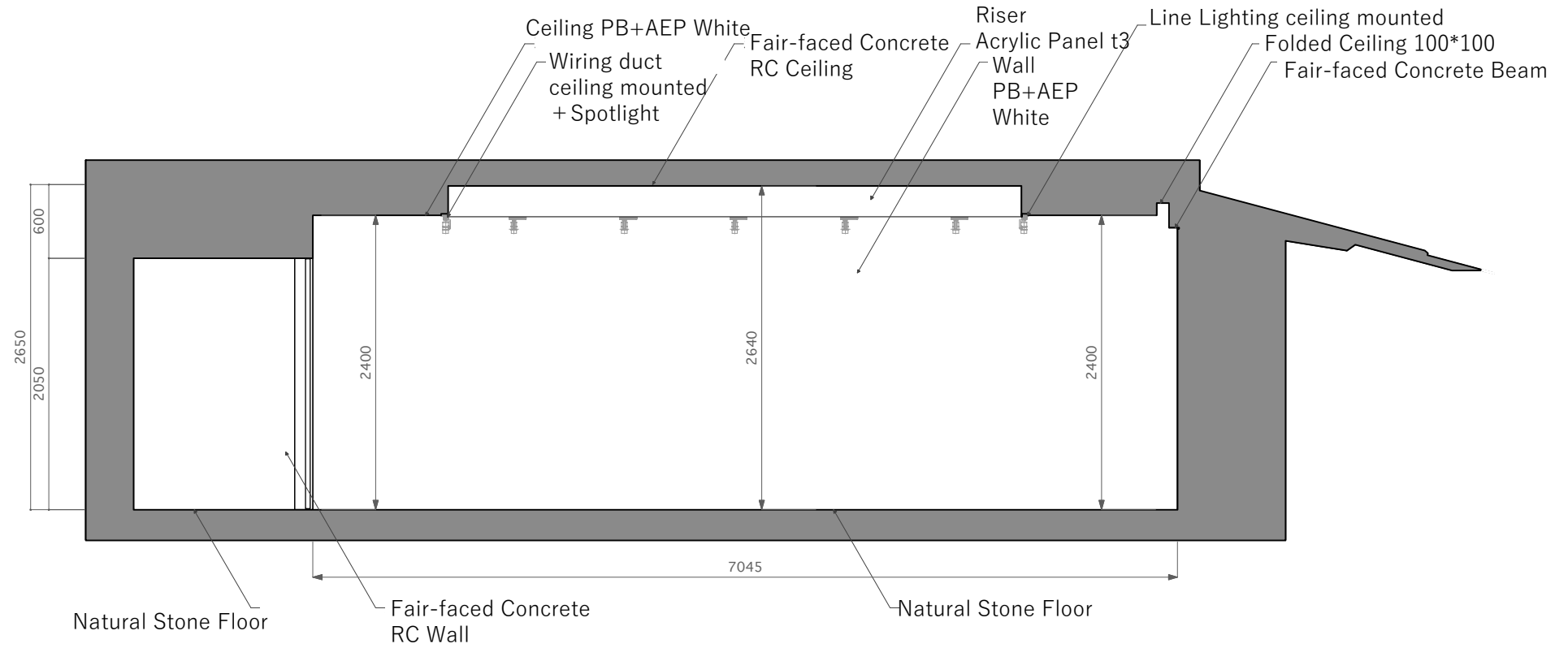

SECTION C-1

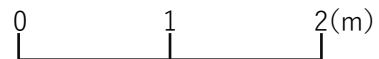
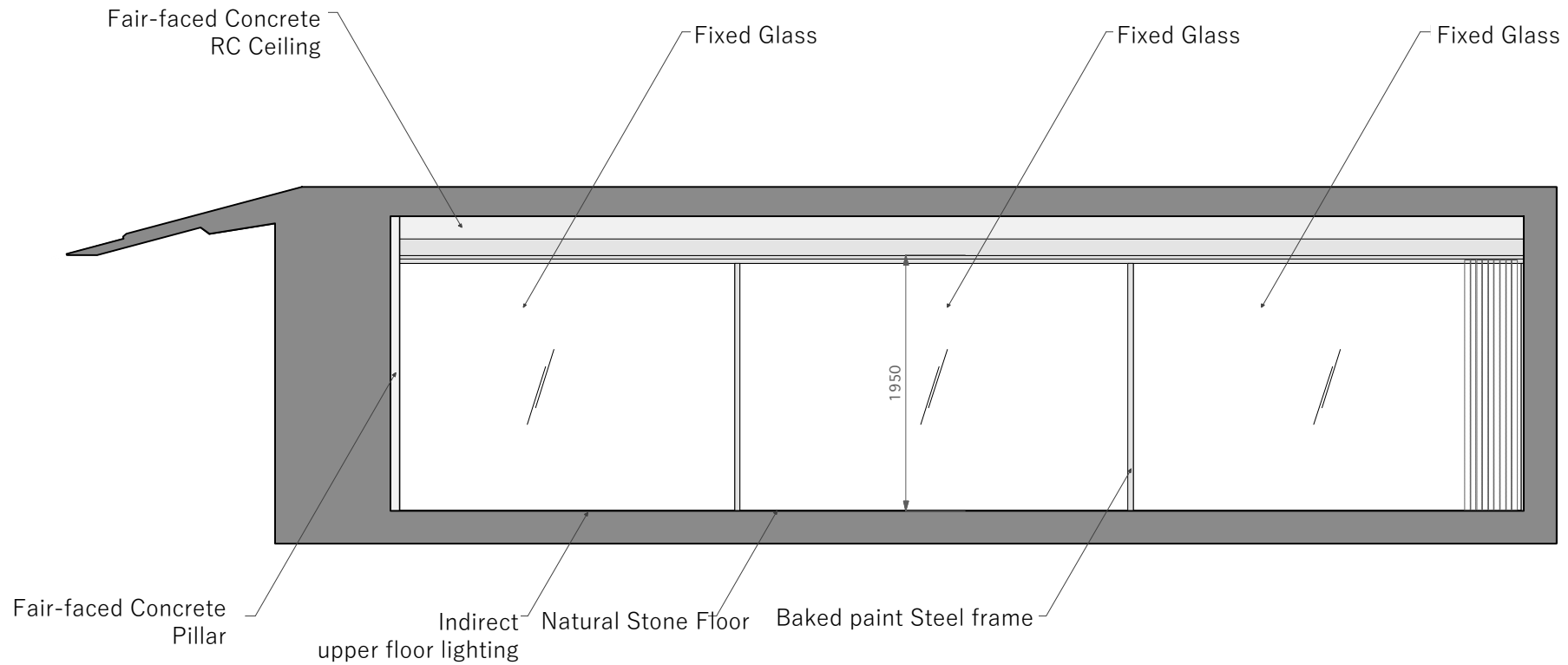

SECTION-2 | Scale 1/50

SECTION B-1

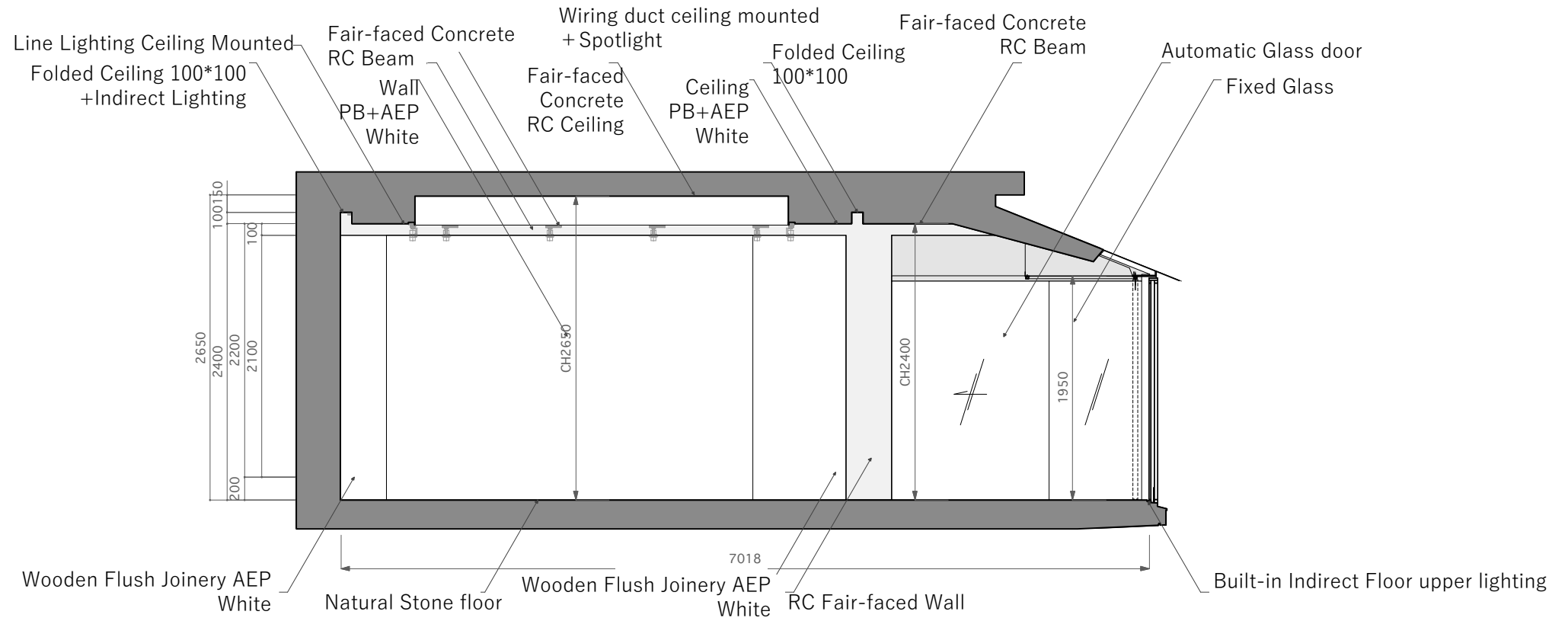

SECTION D-1

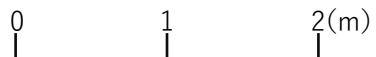
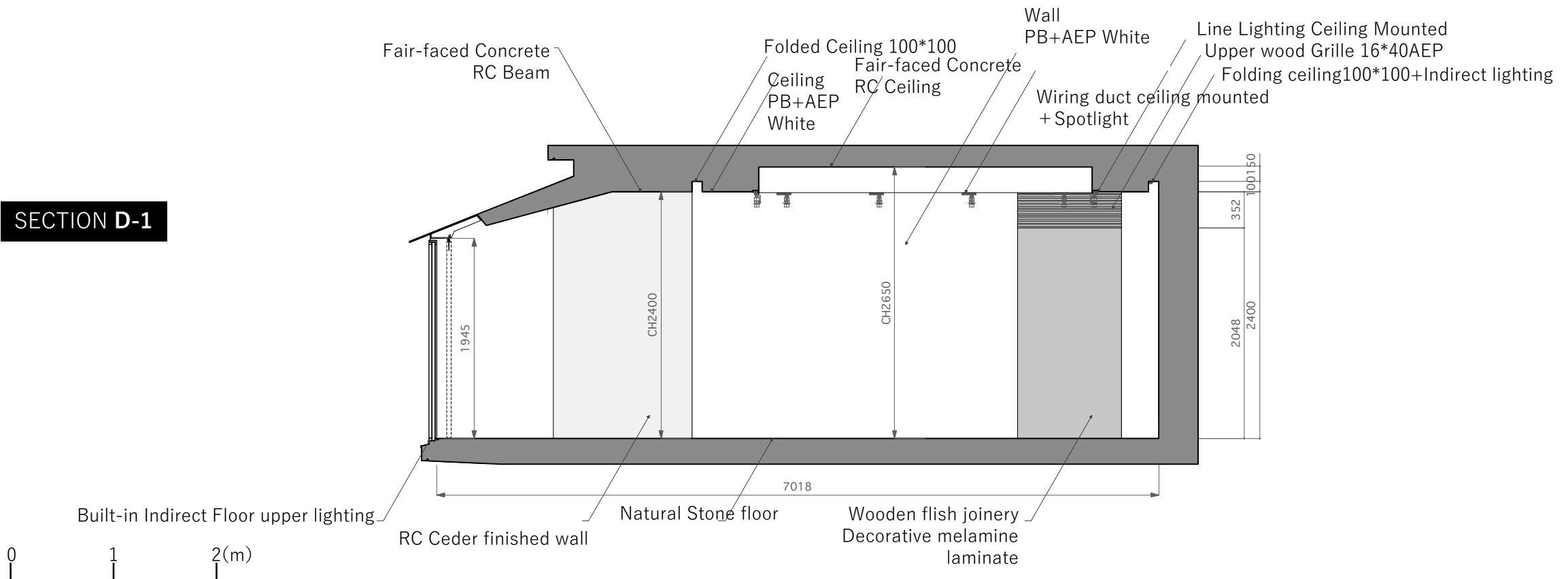

2F

FLOOR Plan | Scale 1/50

kōjin kyoto

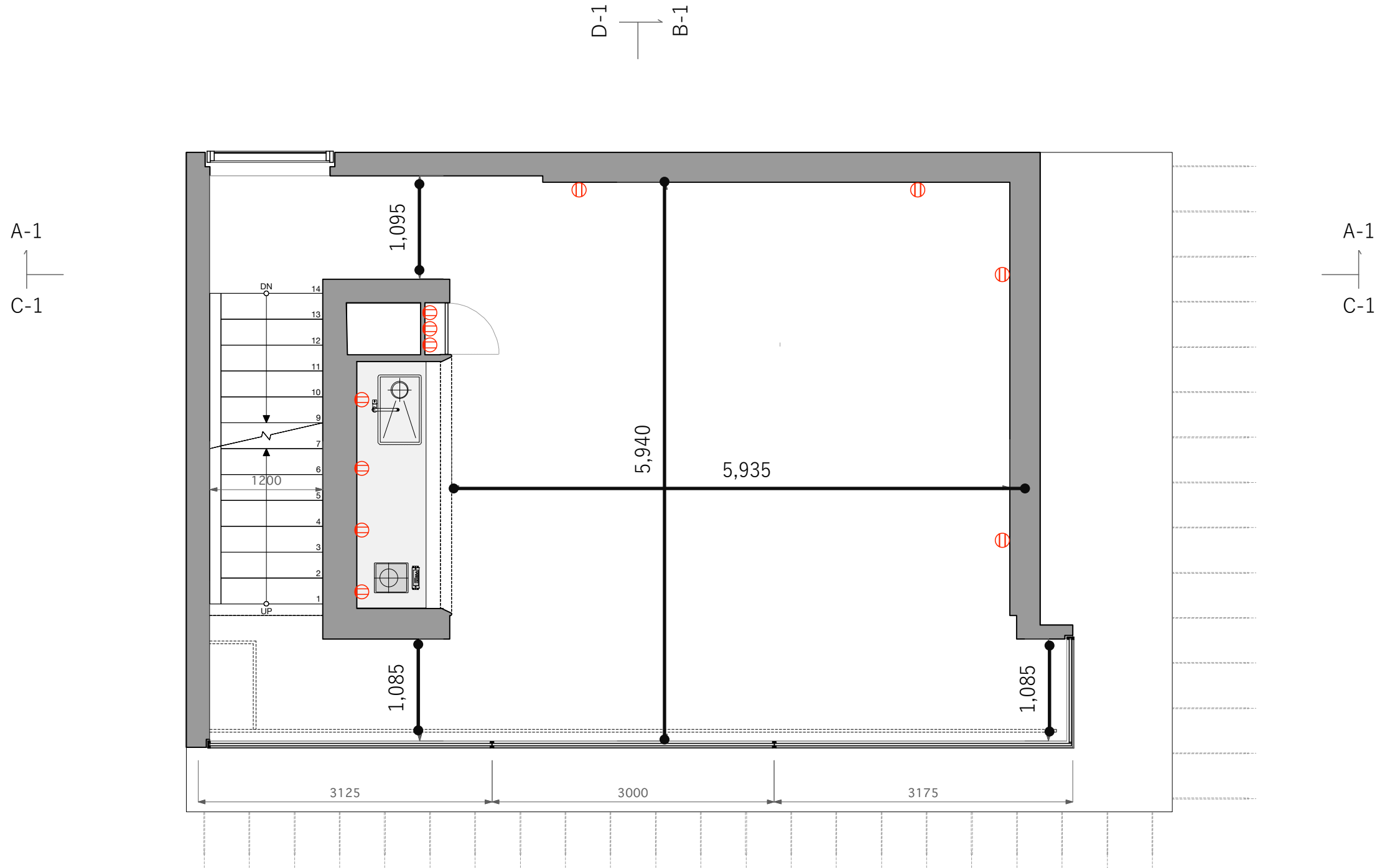

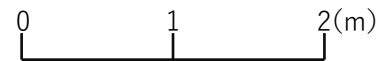

- ⊖ = Floor outlet
- ⊖ = Wall outlet



Plug Spotlight ERS6369W+RB685W+RB-683F	
 SP1	LED(3000K)
	

Line Lighting DDP-3-WC-24V-S/DDP-18WC-24 DDP-24WC-24V	
 (L1/****)	LED (2700-6000K)
	

Indirect Upper Lighting Floor&Stairs NDP-1000-24V-22K	
	LED(2200K)
	

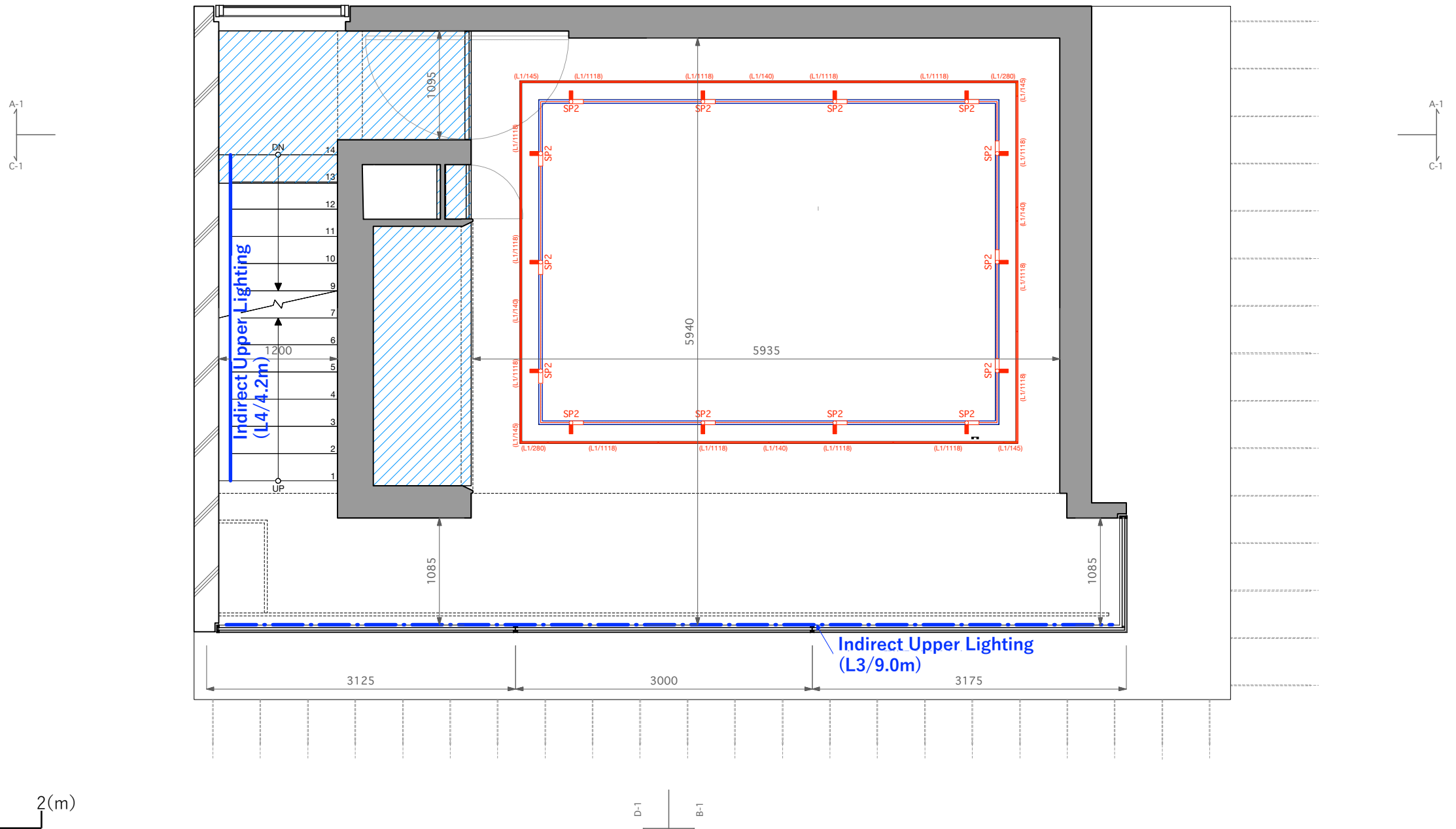

SECTION A-1

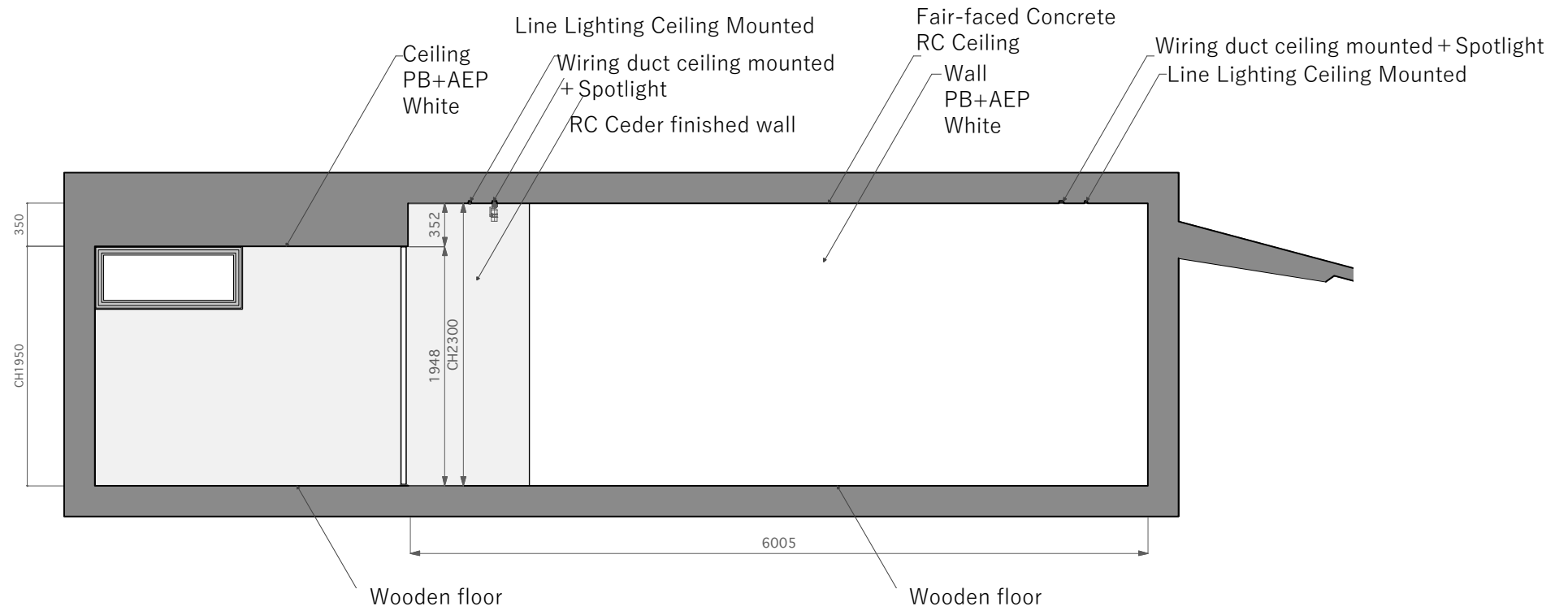

SECTION C-1

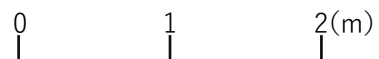
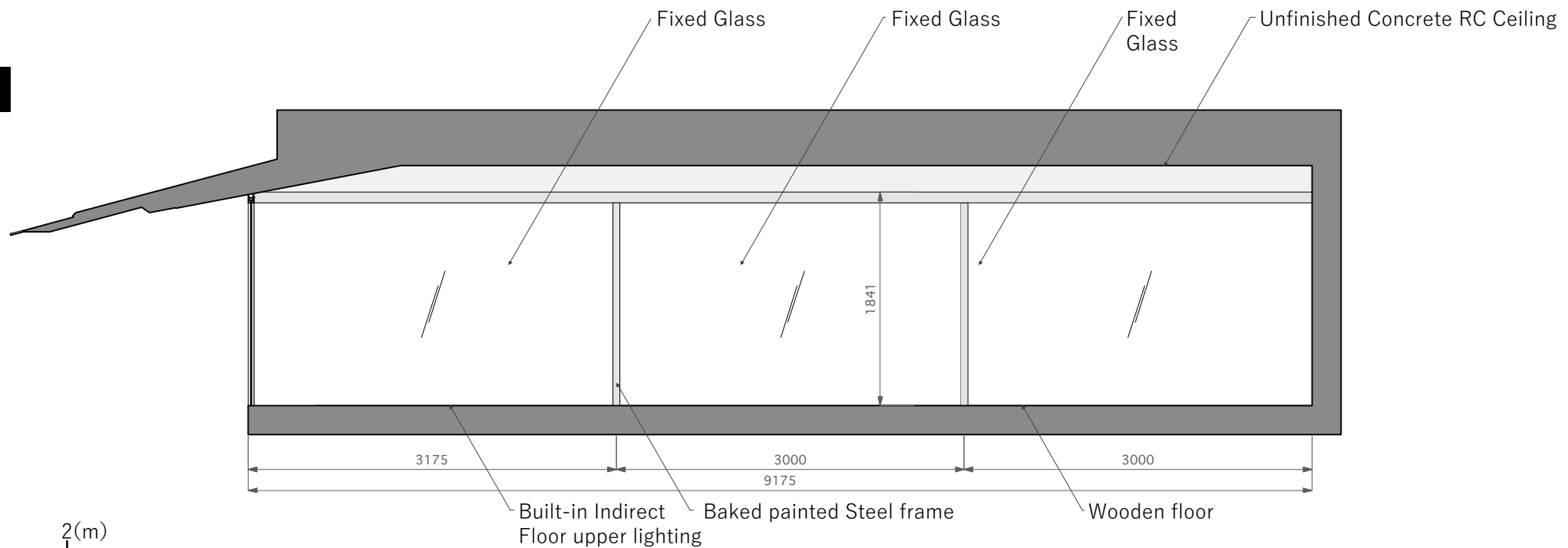

SECTION B-1

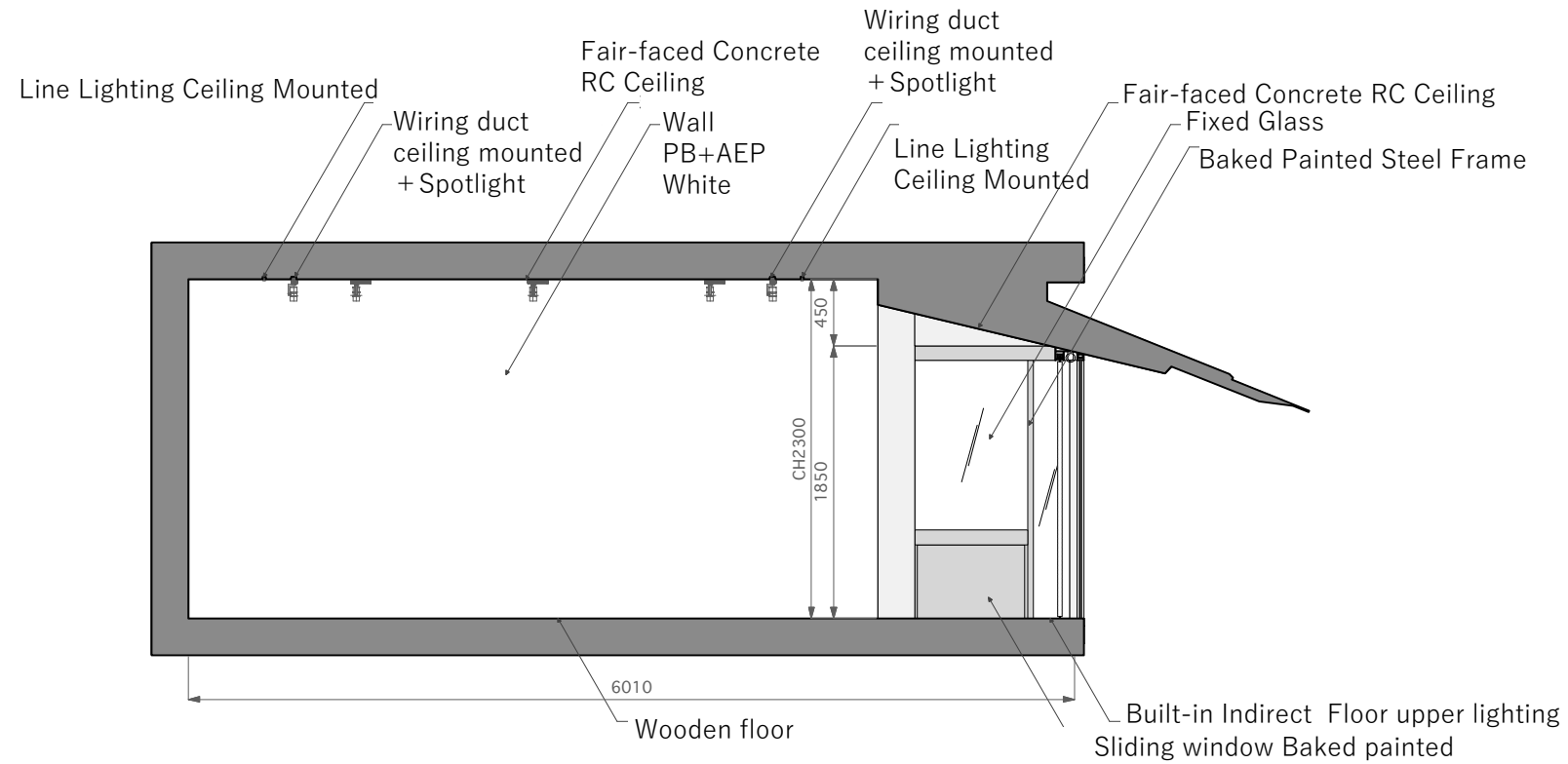

SECTION D-1

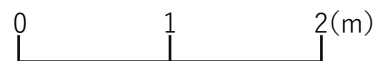
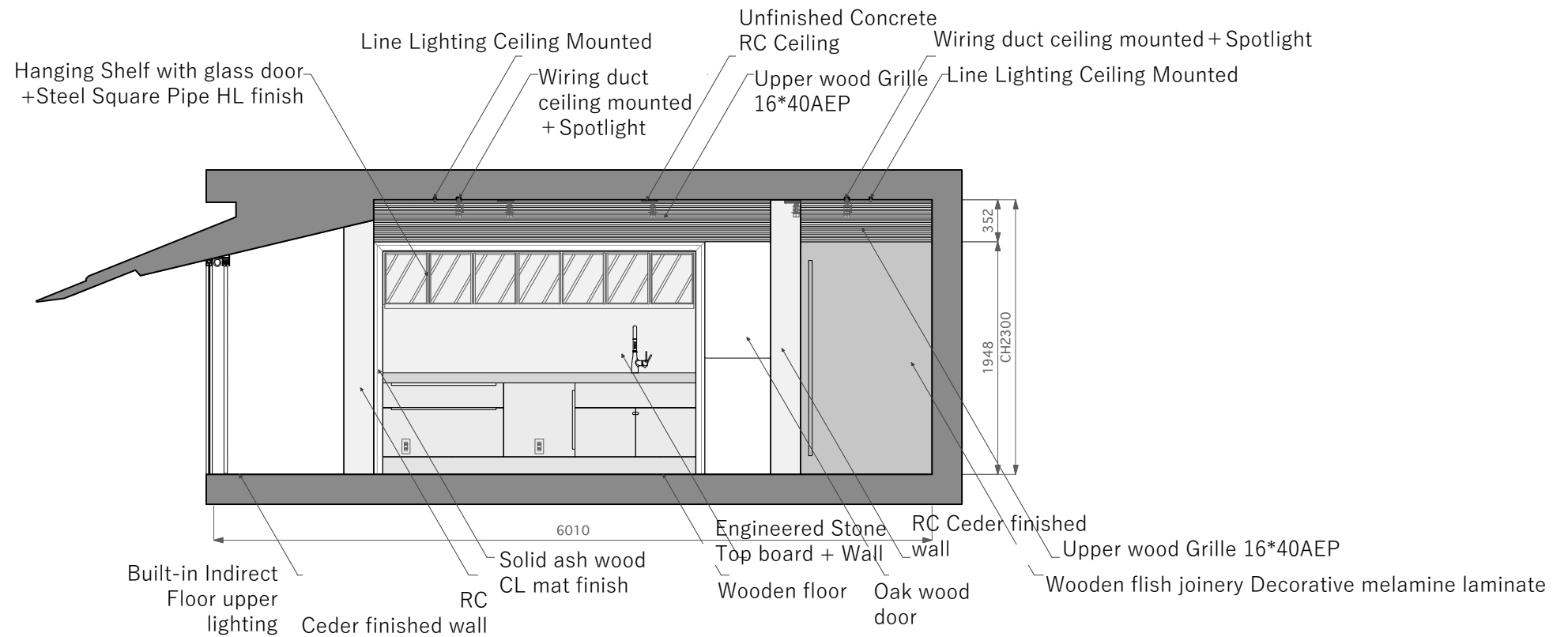

3F

FLOOR Plan | Scale 1/50

kōjin kyoto

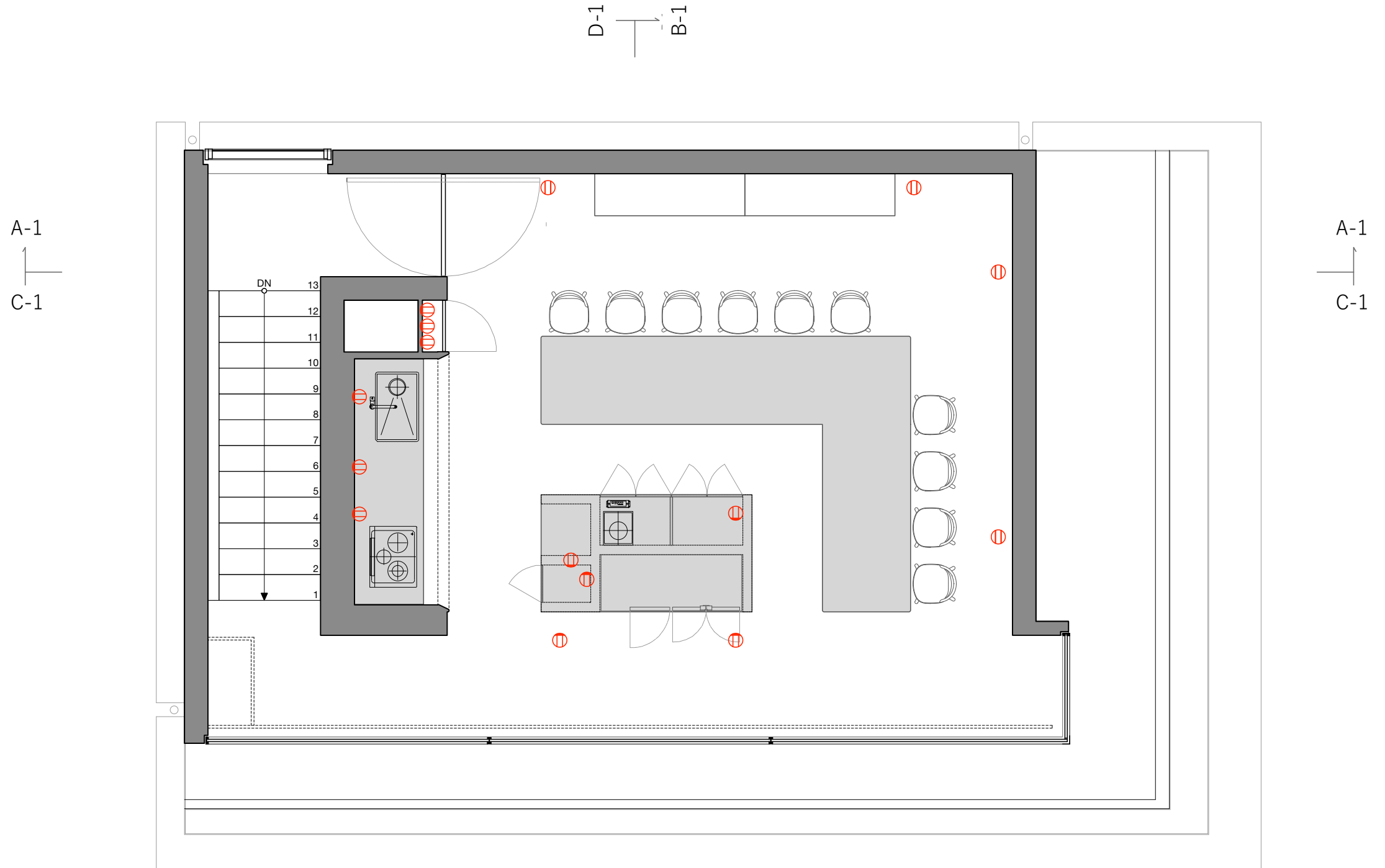

⊖ = Wall outlet

0 1 2(m)

D-1 B-1

Line Lighting DDP-3-WC-24V-S/DDP-18WC-24 DDP-24WC-24V		Indirect Upper Lighting Floor&Stairs NDP-1000-24V-22K	
	LED (2700-6000K)		LED(2200K)

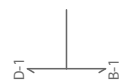
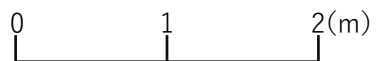
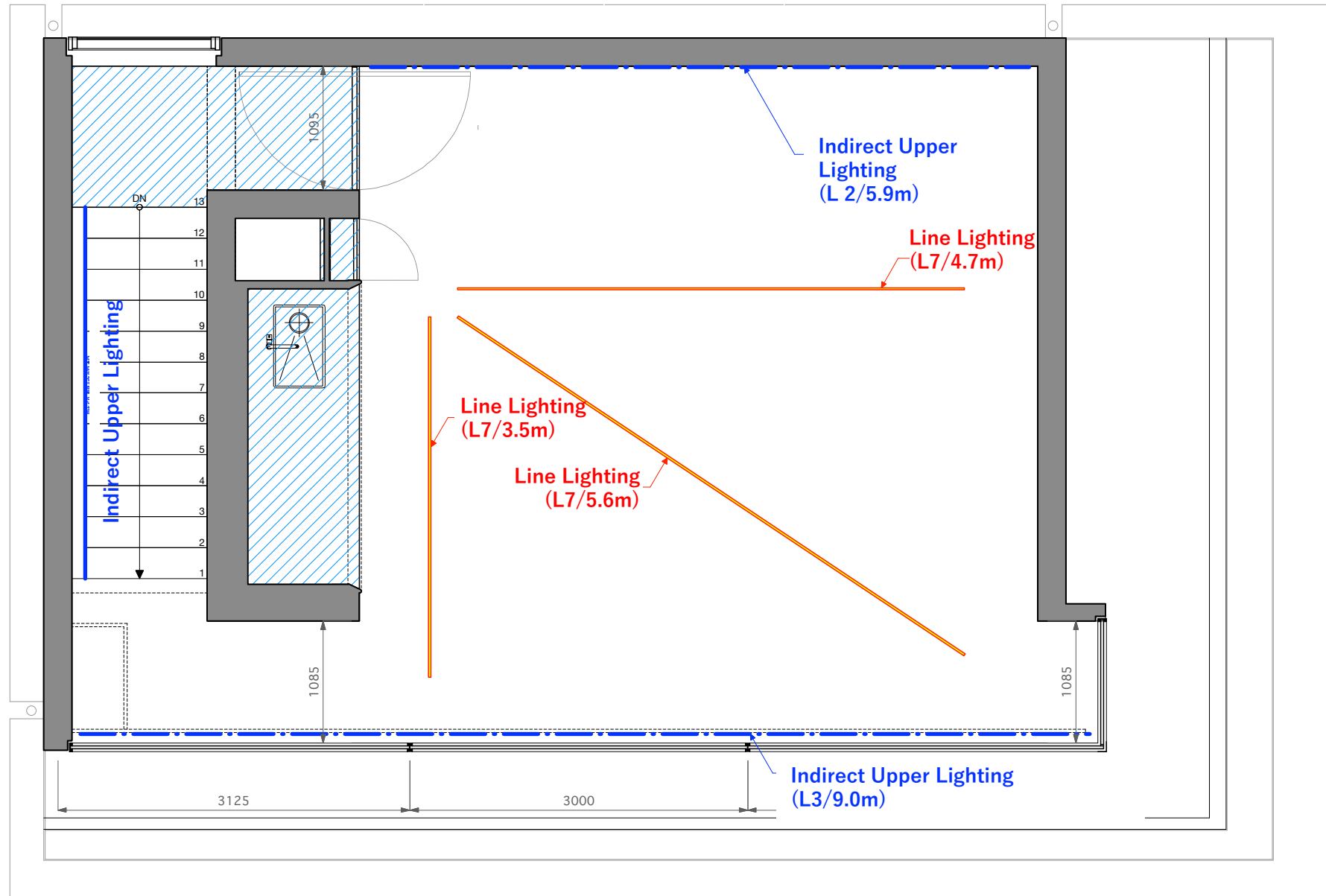

SECTION-1 | Scale 1/50

SECTION A-1

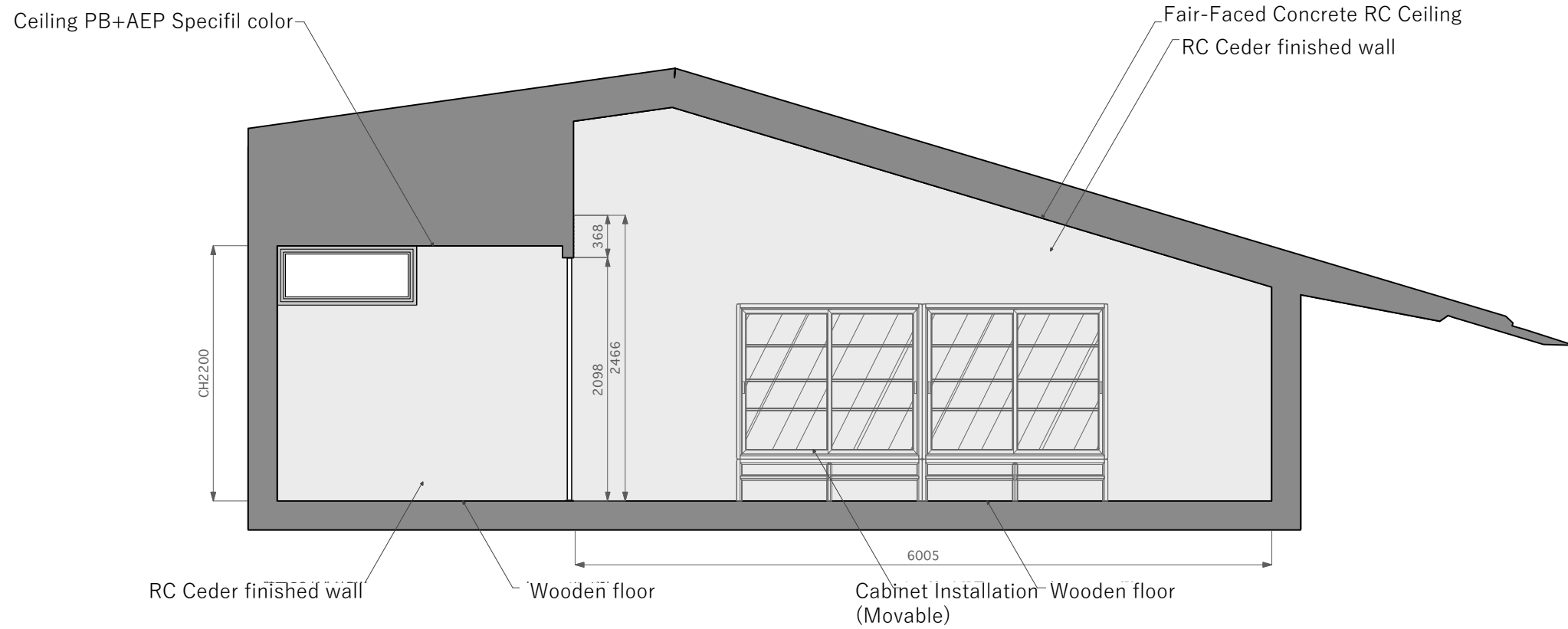

SECTION C-1

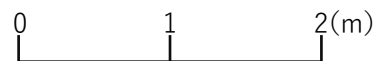
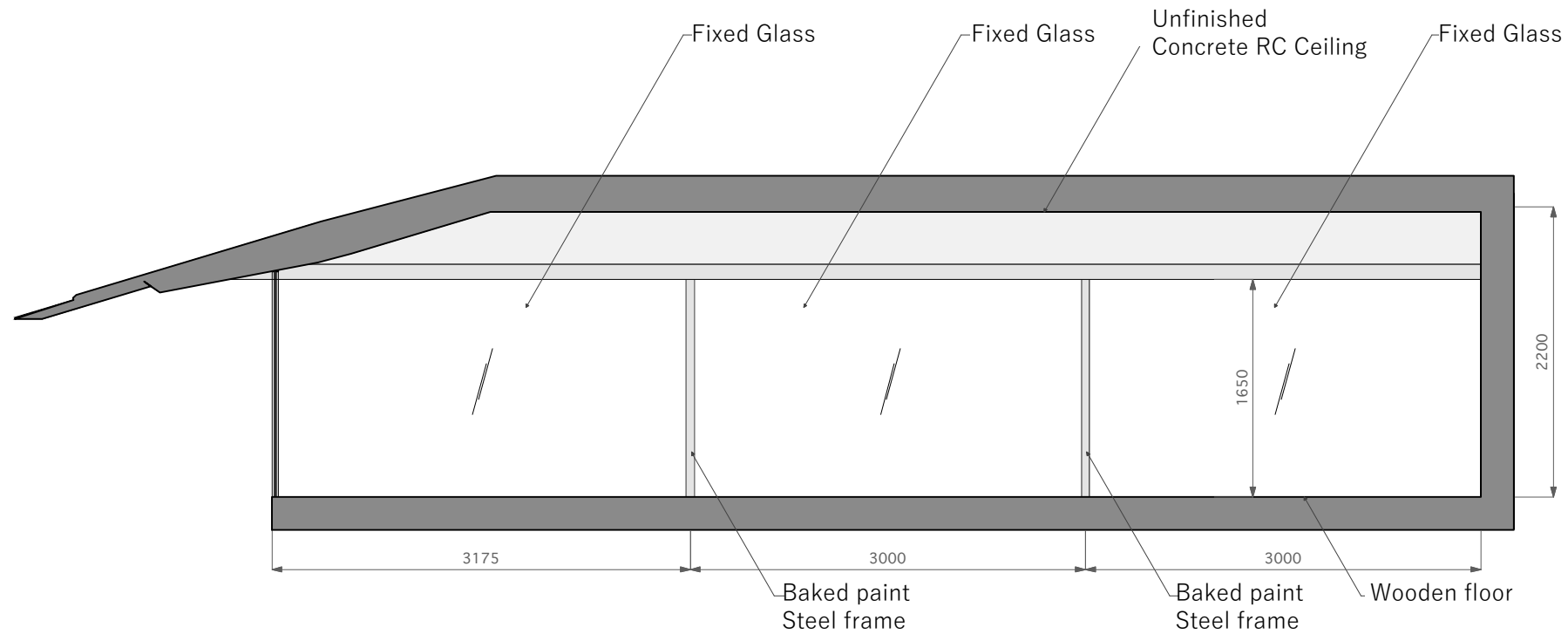

SECTION-2 | Scale 1/50

SECTION B-1

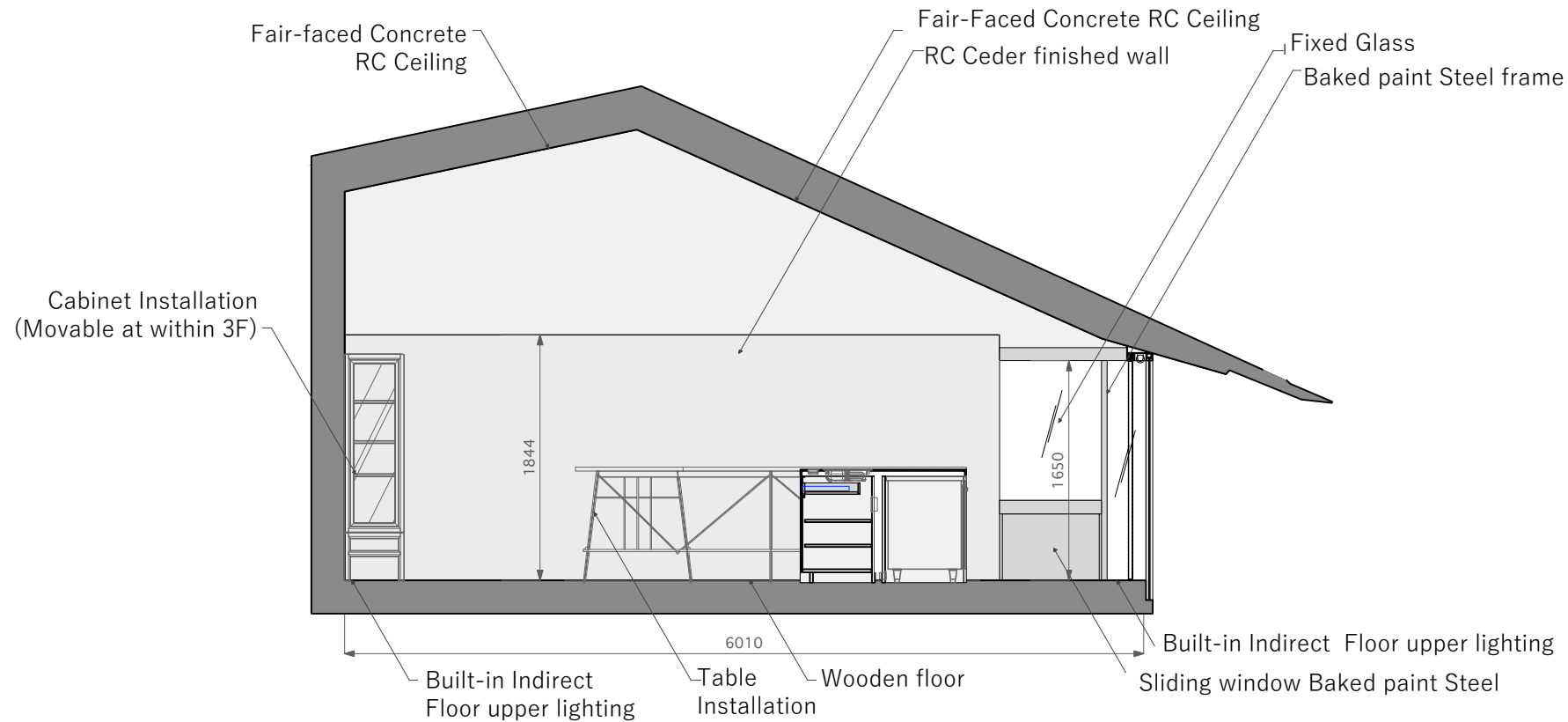

SECTION D-1

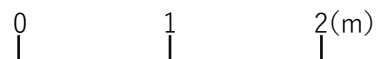
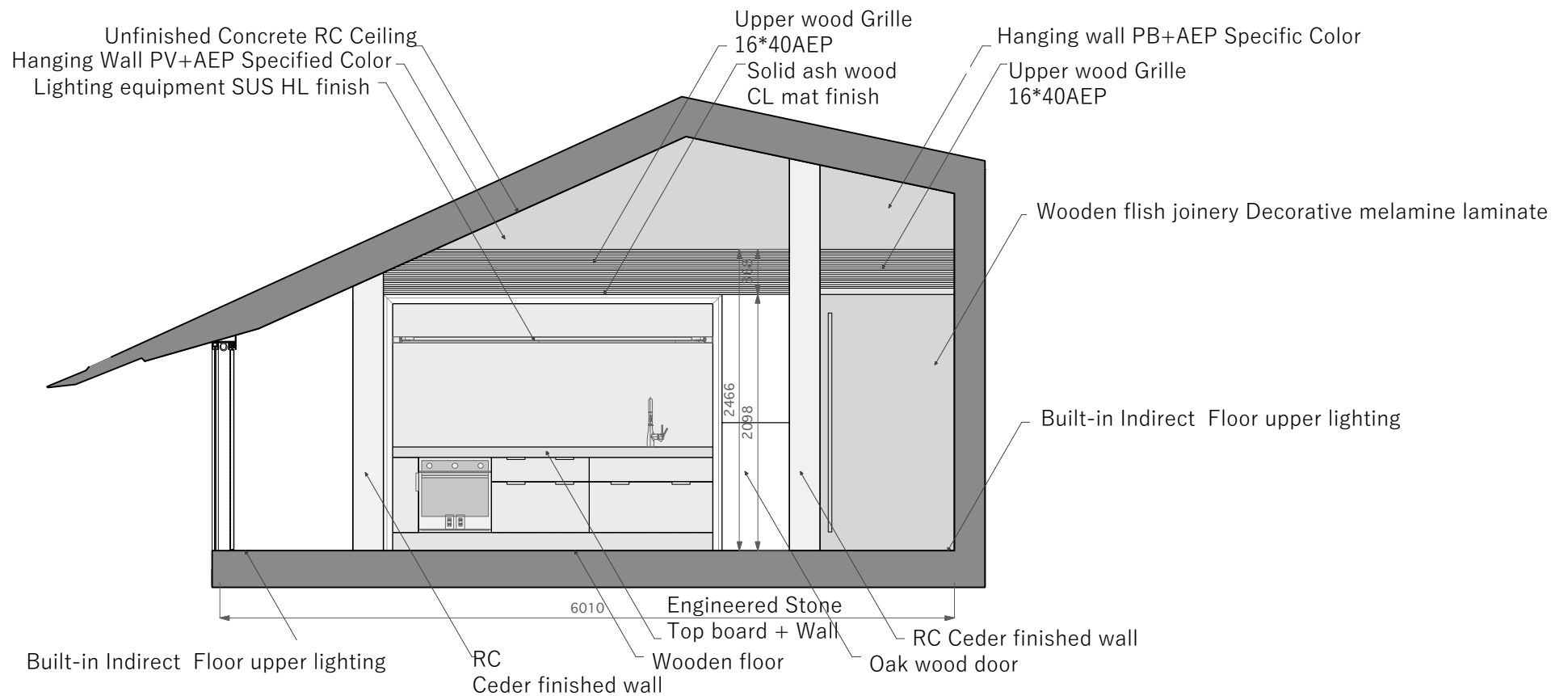

FURNITURE

ITEMS&SIZE

kōjin kyoto

DISPLAY TABLE × 6

W400 × D400 × H700 (mm)



CABINET × 2

W1,600 × D450 (棚板D360) × H1,700 (mm)

詳細図は次ページ参照



LOW TABLE × 1

W1,370 × D740/455 × H700 × SH395 (mm)



PH29 EASY ARMCHAIR × 4

W570 × D740 × H700
× SH370 × AH585 (mm)



PH33 TEAK & CANE BENCH × 1

W1,370 × D740/455
× H700 × SH395 (mm)



artek STOOL 60 × 10

White Lacquer
W380 × D380 × H440 (mm)



ENTRANCE SIGN

ITEMS&SIZE

kōjin kyoto



ENTRANCE SIGN × 1

額縁タイプ

額縁内印刷物サイズ タブロイドサイズW270 × H400

道路側ファサード面に取り外し可能な告知サイン用フレームのご利用が可能です。

